



# **CILÍNDRICO**

# **DIN/1835-A**

**PROGRAMA**

						
<b>PAG. 3-6</b>	<b>PAG. 4-8</b>	<b>PAG. 8</b>	<b>PAG. 9</b>	<b>PAG. 10</b>	<b>PAG. 11</b>	<b>PAG. 11</b>
						
<b>PAG. 12</b>	<b>PAG. 13</b>	<b>PAG. 14</b>	<b>PAG. 15</b>	<b>PAG. 16</b>	<b>PAG. 17</b>	<b>PAG. 17</b>
						
<b>PAG. 18</b>	<b>PAG. 18</b>	<b>PAG. 19</b>	<b>PAG. 19</b>	<b>PAG. 20</b>	<b>PAG. 20</b>	<b>PAG. 21</b>
						
<b>PAG. 22</b>	<b>PAG. 22</b>	<b>PAG. 23</b>	<b>PAG. 23</b>	<b>PAG. 24</b>	<b>PAG. 24</b>	<b>PAG. 25</b>
						
<b>PAG. 25</b>	<b>PAG. 26</b>	<b>PAG. 26</b>				

**DIN/1835A**

Porta pinzas cilíndrico  
Straight shank collet chuck

**ER8M**

**ER11M**

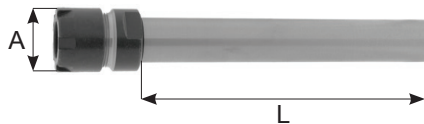
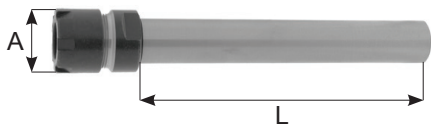

**CAP** 1 ÷ 5mm

Compatible con tuerca mini hexagonal

**CAP** 1 ÷ 7mm

REFERENCIA	CAP	L	A
D5L30ER8M *	1 ÷ 5	30	12
D5L45ER8M *		45	
D6L30ER8M *		30	
D6L45ER8M *		45	
D7L45ER8M *		60	
D8L55ER8M *		55	
D8L80ER8M *		80	
D8L100ER8M *		100	
D8L130ER8M *		130	
D10L80ER8M *		80	
D10L100ER8M *		100	
D12L80ER8M *		80	
D12L100ER8M *		100	
D12L130ER8M *		130	
D12L160ER8M *		160	
D12L200ER8M *		200	

REFERENCIA	CAP	L	A
D6L45ER11M	1 ÷ 7	45	16
D7L45ER11M		45	
D8L55ER11M		55	
D10L60ER11M		60	
D10L100ER11M		100	
D12L70ER11M		70	
D12L100ER11M		100	
D12L140ER11M		140	
D16L40ER11M		40	
D16L60ER11M		60	
D16L100ER11M		100	
D16L130ER11M		130	
D16L160ER11M		160	
D16L200ER11M	200		
D16L250ER11M	250		
D16L300ER11M	300		
D20L70ER11M	70		
D20L100ER11M	100		
D20L130ER11M	130		
D20L160ER11M	160		
D25L100ER11M	100		
D25L160ER11M	160		

\* Porta pinzas cilíndrico sin agujero pasante  
Without coolant bore

Estuche  
portapinzas  
Straight shank  
collet chuck kit



Estuche  
portapinzas  
Straight shank  
collet chuck kit



REFERENCIA	CAP
BD12L100ER8M	1 ÷ 5 mm
BD12L130ER8M	
BD12L160ER8M	
BD12L200ER8M	

REFERENCIA	CAP
BD12L100ER11M	1 ÷ 7 mm
BD16L100ER11M	
BD16L130ER11M	
BD16L160ER11M	
BD20L160ER11M	
BD25L160ER11M	

**COMPOSICION**  
Llave - CH8M  
Pinzas - Ø 1 a Ø 5 x 0.5mm ( 9 Unidades )  
Portapinzas - ER8M

**COMPOSICION**  
Llave - CH11M o CH11MSE  
Pinzas - Ø 1 a Ø 7 x 0.5mm (13 Unidades)  
Portapinzas - ER11M

**DIN/1835A**

Porta pinzas cilíndrico  
Straight shank collet chuck

**ER16M**

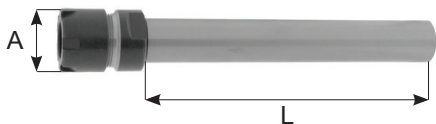

**ER16**

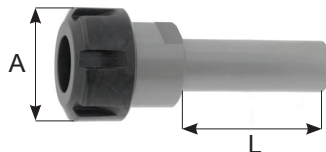

Compatible con tuerca mini hexagonal

**CAP 1 ÷ 10mm**

REFERENCIA	CAP	L	A
D10L80ER16M		80	
D12L80ER16M		80	
D16L35ER16M		35	
D16L80ER16M		80	
D16L100ER16M		100	
D16L130ER16M		130	
D16L160ER16M		160	
D16L200ER16M		200	
D20L60ER16M		60	
D20L100ER16M		100	
D20L130ER16M	1 ÷ 10	130	22
D20L160ER16M		160	
D20L200ER16M		200	
D20L270ER16M		270	
D20L300ER16M		300	
D22L80ER16M		80	
D25L60ER16M		60	
D25L100ER16M		100	
D25L130ER16M		130	
D25L160ER16M		160	
D32L90ER16M		90	

Compatible con tuerca hexagonal

**CAP 1 ÷ 10mm**

REFERENCIA	CAP	L	A
D16L35ER16		35	
D16L60ER16		60	
D16L160ER16		160	
D20L50ER16	1 ÷ 10	50	32
D20L60ER16		60	
D20L100ER16		100	
D20L160ER16		160	
D20L200ER16		200	

Estuche portapinzas  
Straight shank collet chuck kit



REFERENCIA	CAP
BD20L100ER16M	
BD20L130ER16M	
BD20L160ER16M	1 ÷ 10
BD20L200ER16M	

**COMPOSICION**

Llave - CH16M o CH16MSE  
Pinzas - Ø 1 a Ø 10 x 1.0 mm (10 Unidades)  
Portapinzas - ER16M

REFERENCIA	CAP
BD20L100ER16	
BD20L160ER16	1 ÷ 10

**COMPOSICION**

Llave - CH16S o CH16SE  
Pinzas - Ø 1 a Ø 10 x 1.0 mm (10 Unidades)  
Portapinzas - ER16

**DIN/1835A**

Porta pinzas cilíndrico  
Straight shank collet chuck

**ER20M**

**ER20**

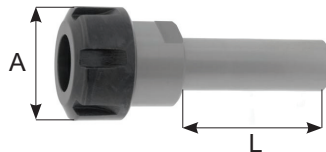
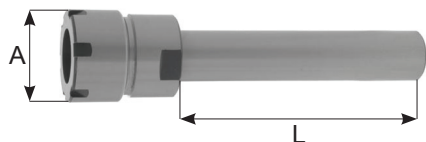

Compatible con tuerca mini hexagonal

**CAP** 1 ÷ 13mm

Compatible con tuerca hexagonal

**CAP** 1 ÷ 13mm

REFERENCIA	CAP	L	A
D16L100ER20M	1 ÷ 14	100	28
D16L130ER20M		130	
D16L160ER20M		160	
D20L46ER20M		46	
D20L60ER20M		60	
D20L100ER20M		100	
D20L130ER20M		130	
D20L160ER20M		160	
D20L200ER20M		200	
D25L60ER20M		60	
D25L130ER20M		130	
D25L160ER20M		160	
D25L240ER20M		240	
D25L300ER20M		300	
D32L95ER20M		95	

REFERENCIA	CAP	L	A
D20L50ER20	1 ÷ 14	50	35
D20L60ER20		60	
D20L100ER20		100	
D20L130ER20		130	
D20L160ER20		160	
D20L200ER20		200	
D25L100ER20		100	

Estuche portapinzas  
Straight shank collet chuck kit

Estuche portapinzas  
Straight shank collet chuck kit



REFERENCIA	CAP
BD20L100ER20M	2 ÷ 13
BD20L130ER20M	
BD20L160ER20M	
BD20L200ER20M	

REFERENCIA	CAP
BD20L100ER20	2 ÷ 13
BD20L200ER20	
BD25L100ER20	

**COMPOSICION**

Llave - CH20M o CH20MSE  
Pinzas - Ø 2 a Ø 13 x 1.0 mm (12 Unidades)  
Portapinzas - ER20M

**COMPOSICION**

Llave - CH20S o CH20SE  
Pinzas - Ø 2 a Ø 13 x 1.0 mm (12 Unidades)  
Portapinzas - ER20

**DIN/1835A**

Porta pinzas cilíndrico  
Straight shank collet chuck

**ER25M**

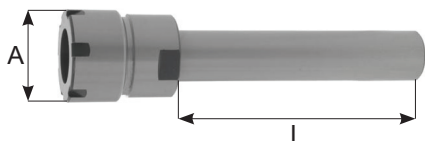

**ER25**

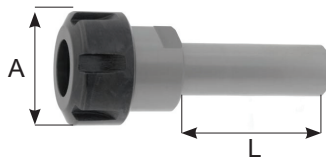

Compatible con tuerca mini hexagonal

**CAP** 1 ÷ 20mm

REFERENCIA	CAP	L	A
D20L46ER25M		46	
D20L60ER25M		60	
D20L100ER25M		100	
D20L130ER25M		130	
D20L160ER25M		160	
D20L200ER25M	1 ÷ 20	200	35
D25L70ER25M		70	
D25L100ER25M		100	
D25L130ER25M		130	
D25L160ER25M		160	
D25L260ER25M		260	

Compatible con tuerca hexagonal

**CAP** 1 ÷ 20mm

REFERENCIA	CAP	L	A
D20L50ER25		50	
D20L60ER25		60	
D20L100ER25		100	
D20L130ER25		130	
D20L160ER25		160	
D25L50ER25		50	
D25L70ER25	1 ÷ 20	70	42
D25L100ER25		100	
D25L130ER25		130	
D25L160ER25		160	
D32L80ER25		80	
D32L100ER25		100	
D40L80ER25		80	

Estuche portapinzas  
Straight shank collet chuck kit



REFERENCIA	CAP
BD20L100ER25M	
BD20L130ER25M	
BD20L160ER25M	
BD20L200ER25M	
BD25L100ER25M	
BD25L160ER25M	
	2 ÷ 1

**COMPOSICION**

Llave - CH25M o CH25MSE  
Pinzas - Ø 2 a Ø 16 x 1.0 mm (15 Unidades)  
Portapinzas - ER25M

Estuche portapinzas  
Straight shank collet chuck kit



REFERENCIA	CAP
BD20L50ER25	
BD25L100ER25	
BD32L80ER25	
	2 ÷ 16

**COMPOSICION**

Llave - CH25S o CH25SE  
Pinzas - Ø 2 a Ø 16 x 1.0 mm (15 Unidades)  
Portapinzas - ER25

**DIN/1835A**

Porta pinzas cilíndrico  
Straight shank collet chuck

**ER32**

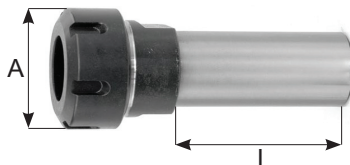

**CAP** 2 ÷ 22mm

**CAP** 2 ÷ 22mm

REFERENCIA	CAP	L	A
D20L50ER32	2 ÷ 22	50	50
D20L100ER32		100	
D20L130ER32		130	
D20L160ER32		160	
D25L50ER32		50	
D25L70ER32		70	
D25L100ER32		100	
D25L130ER32		130	
D25L160ER32		160	
D32L50ER32		50	

REFERENCIA	CAP	L	A
D32L70ER32	2 ÷ 22	70	50
D32L100ER32		100	
D32L130ER32		130	
D32L160ER32		160	
D40L80ER32		80	
D40L130ER32		130	
D40L160ER32		160	
D50L160ER32		160	
D60L160ER32		160	

Estuche portapinzas  
Straight shank collet chuck kit



Estuche portapinzas  
Straight shank collet chuck kit



REFERENCIA	CAP
BD20L50ER32-6	6 ÷ 25
BD25L50ER32-6	
BD32L70ER32-6	

**COMPOSICION**

Llave - CH32S  
Pinzas - Ø6 - Ø8 - Ø10 - Ø12 - 16 - Ø 20 - Ø25  
(6 Unidades) + Portapinzas - ER32

REFERENCIA	CAP
BD20L50ER32-9	3 ÷ 20
BD25L50ER32-9	
BD32L70ER32-9	

**COMPOSICION**

Llave - CH32S  
Pinzas - Ø3 - Ø4 - Ø5 - Ø6 - Ø8 - Ø10 - Ø12  
Ø16 - Ø20 (9 Unidades) + Portapinzas

REFERENCIA	CAP
BD20L50ER32-18	3 ÷ 20
BD25L50ER32-18	
BD32L70ER32-18	

**COMPOSICION**

Llave - CH32S  
Pinzas - Ø 3 a Ø 20 x 1.0 mm (18 Unidades)  
Portapinzas - ER32

**DIN/1835A**

Porta pinzas cilíndrico  
Straight shank collet chuck

**ER40**

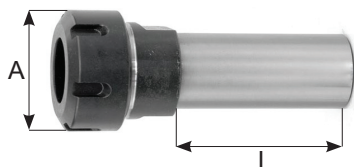

**ER50**

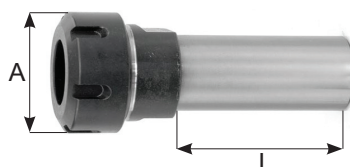

**CAP** 3 ÷ 30mm

**CAP** 6 ÷ 34mm

REFERENCIA	CAP	L	A
D25L60ER40	3 ÷ 30	60	63
D25L100ER40		100	
D32L70ER40		70	
D32L100ER40		100	
D32L130ER40		130	
D40L80ER40		80	
D40L130ER40		130	
D40L160ER40		160	
D50L120ER40		120	
D50L160ER40		160	
D60L160ER40		160	

REFERENCIA	CAP	L	A
D40L160ER50	6 ÷ 34	160	78
D50L170ER50		170	
D60L170ER50		170	

**DIN/1835A**

Porta pinzas doble  
Double ended collet chucks

**TUERCA MINI DOBLE**



REFERENCIA	CAP	L	A	H
D20L42ER11MP	1 ÷ 7	42	16	70
D20L52ER11MP		52		80
D20L62ER11MP		62		90
D20L37ER16MP	1 ÷ 10	37	22	80
D20L57ER16MP		57		100
D20L67ER16MP		67		110
D20L122ER16MP		122		165
D22L47ER16MP		47		90
D22L67ER16MP		67		110
D22L102ER16MP		102		145
D25L27ER16MP		27		70
D25L47ER16MP		47		90
D25L67ER16MP		67		110
D25L82ER20MP	1 ÷ 14	82	28	130
D32L57ER20MP		57		105
D32L82ER20MP		82		130



DIN/1835A

Porta pinzas cilíndrico con plano de bloqueo  
Collet chuck with flat

**TUERCA MINI**

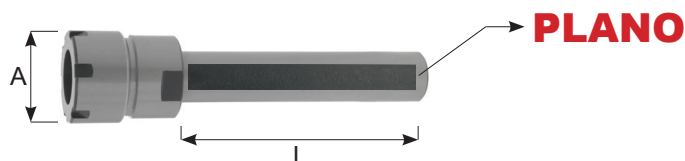

REFERENCIA	CAP	L	A	REFERENCIA	CAP	L	A	
D20PL50ER11M	1 ÷ 7	50	16	D20PL46ER20M	1 ÷ 14	46	28	
D20PL100ER11M		100		D20PL60ER20M		60		
D20PL130ER11M		130		D20PL100ER20M		100		
D20PL160ER11M		160		D20PL130ER20M		130		
D20PL200ER11M		200		D20PL160ER20M		160		
D25PL100ER11M		50		D20PL200ER20M		200		
D25PL130ER11M		100		D20PL250ER20M		250		
D25PL160ER11M	130	D25PL60ER20M	60					
D20PL60ER16M	1 ÷ 10	60	22	D25PL100ER20M		100		90
D20PL100ER16M		100		D25PL130ER20M		130		
D20PL130ER16M		130		D25PL160ER20M		160		
D20PL160ER16M		160		D25PL200ER20M		200		
D20PL200ER16M		200		D32PL90ER20M		90		
D20PL250ER16M		250		D20PL46ER25M		46		
D25PL60ER16M		60		D20PL60ER25M	60			
D25PL100ER16M		100		D20PL100ER25M	100			
D25PL130ER16M		130		D20PL130ER25M	130			
D25PL160ER16M		160		D20PL160ER25M	160			
D25PL200ER16M		200		D25PL50ER25M	46			
D32PL90ER16M		60		D25PL70ER25M	60			
						D25PL100ER25M	100	
				D25PL130ER25M	130			
				D25PL160ER25M	160			
				D25PL200ER25M	200			



DIN/1835A

Porta pinzas cilíndrico con plano de bloqueo  
Collet chuck with flat

**TUERCA STANDARD**

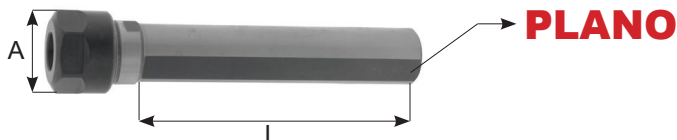

\*Compatible con tuerca hexagonal

REFERENCIA	CAP	L	A	REFERENCIA	CAP	L	A
D20PL50ER16 *	1 ÷ 10	50	32	D20PL50ER32	2 ÷ 22	50	50
D20PL100ER16 *		100		D20PL100ER32		100	
D20PL130ER16 *		130		D20PL130ER32		130	
D20PL160ER16 *		160		D20PL160ER32		160	
D20PL200ER16 *		200		D25PL50ER32		50	
D25PL60ER16 *		60		D25PL70ER32		70	
D25PL100ER16 *		100		D25PL100ER32		100	
D25PL130ER16 *		130		D25PL130ER32		130	
D25PL160ER16 *		160		D25PL160ER32		160	
D25PL200ER16 *		200		D32PL50ER32		50	
D32PL100ER16 *		100		D32PL70ER32		70	
D32PL150ER16 *		150		D32PL100ER32		100	
D20PL46ER20 *		1 ÷ 14		46		35	
D20PL60ER20 *	60		D32PL150ER32	150			
D20PL100ER20 *	100		D40PL70ER32	70			
D20PL130ER20 *	130		D40PL100ER32	100			
D20PL160ER20 *	160		D40PL130ER32	130			
D20PL200ER20 *	200		D40PL160ER32	160			
D25PL60ER20 *	60		D50PL125ER32	125			
D25PL100ER20 *	100		D50PL160ER32	160			
D25PL130ER20 *	130		D60PL160ER32	160			
D25PL160ER20 *	160						
D32PL100ER20 *	100						
D32PL150ER20 *	150						
D20PL50ER25	1 ÷ 20		50	42	D25PL50ER40		3 ÷ 30
D20PL100ER25		100	D25PL100ER40		100		
D20PL130ER25		130	D32PL50ER40		50		
D20PL160ER25		160	D32PL70ER40		70		
D25PL50ER25		50	D32PL100ER40		100		
D25PL70ER25		70	D32PL130ER40		130		
D25PL100ER25		100	D40PL50ER40		50		
D25PL130ER25		130	D40PL80ER40		80		
D25PL160ER25		160	D40PL130ER40		130		
D32PL70ER25		70	D50PL125ER40		125		
D32PL100ER25		100	D50PL160ER40		160		
D32PL120ER25		120	D60PL160ER40		160		
D32PL150ER25		150					
D40PL70ER25	70						
D40PL120ER25	120						

DIN/1835B

Porta pinzas radial regulable  
Adjustable collet chucks

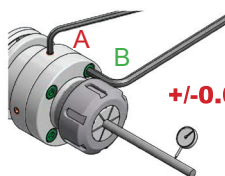
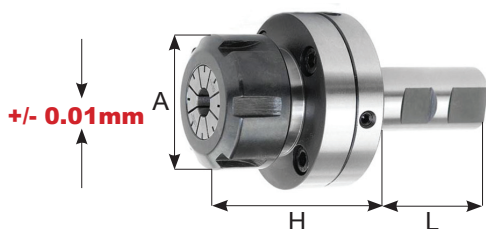

"Afloje los tornillos B y ajuste el centrado con los tornillos A"  
"Loosen screws B and use screws A for radial adjustment"

REFERENCIA	CAP	L	A	AJUSTE
D25L70ER16RG	1 ÷ 10	70	28	+/-0.01
D32L70ER16RG				
D40L70ER16RG				
D25L70ER20RG	1 ÷ 14	70	34	+/-0.01
D32L70ER20RG				
D40L70ER20RG				
D25L70ER25RG	1 ÷ 20	70	42	+/-0.01
D32L70ER25RG				
D40L70ER25RG				
D25L70ER32RG	2 ÷ 22	70	50	+/-0.01
D32L70ER32RG				
D40L70ER32RG				
D25L70ER40RG	3 ÷ 30	70	63	+/-0.01
D32L70ER40RG				
D40L70ER40RG				

DIN/1835B

Porta cilindrico hidráulico  
Hydraulic cylindrical holder

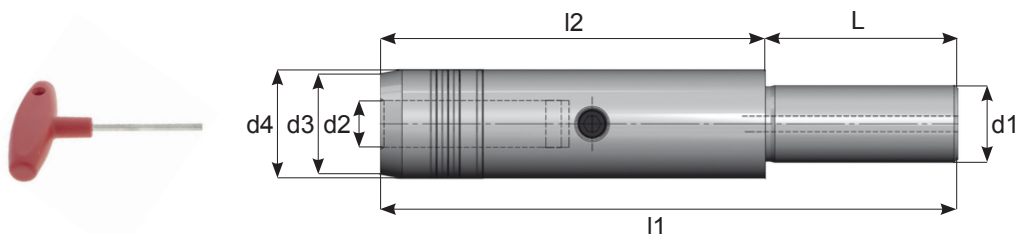

REFERENCIA	d1	d2	d3	d4	l1	l2	L
D12L46HD12	12	12	21	25	146	100	46
D20L50HD12	20	12	21	25	150	100	50
D20L50HD16	20	16	25	28	150	100	50
D20L50HD20	20	20	30	32	150	100	50
D22L50HD12	22	12	29	32	132.5	62.5	70
D32L60HD12	32	12	21	25	200	140	60
D32L60HD16	32	16	25	28	200	140	60
D32L60HD20	32	20	30	32	200	140	60

**DIN/1835A**

Porta pinzas cilíndrico MINI  
Collet chuck extensions mini

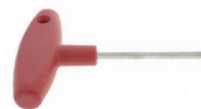
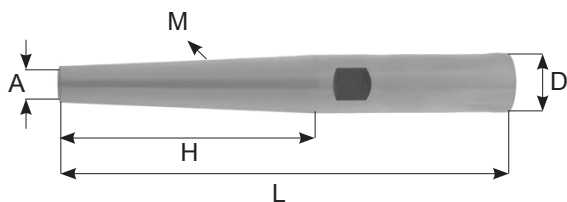

Se entrega con llave de bloqueo hexagonal 5mm  
Are supplied with T-handle key exagonal 5 mm

REFERENCIA	D	A	L	L1
D16L120P8	16	12	120	48
D16L150P8			150	48
D16L200P8			200	48
D20L120P8	20	12	120	76.5
D20L150P8			150	86
D20L200P8			200	76.5
D25L120P8	25	14	120	60
D25L150P8			150	60
D25L200P8			200	60

Pinza P8  
Collet P8



REFERENCIA	L	A
P8D3	36	10
P8D4		
P8D5		
P8D6		

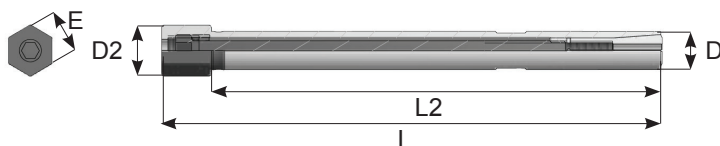

REFERENCIA	D	D2	L	L2	E
D12L120P8	12	12	130	110	14
D12L150P8	12	12	160	114	14

Kit - Porta pinzas - Llave - Pinza  
Kit - Toolholder - Wrench and collets

REFERENCIA	Juego pinzas	Portapinzas + llave
BD12L120P8	P8 Ø 3-4-5-6	D12L120P8
BD12L150P8	P8 Ø 3-4-5-6	D12L150P8
BD16L120P8	P8 Ø 3-4-5-6	D16L120P8
BD16L150P8	P8 Ø 3-4-5-6	D16L150P8
BD16L200P8	P8 Ø 3-4-5-6	D16L200P8
BD20L120P8	P8 Ø 3-4-5-6	D20L120P8
BD20L150P8	P8 Ø 3-4-5-6	D20L150P8
BD20L200P8	P8 Ø 3-4-5-6	D20L200P8
BD25L120P8	P8 Ø 3-4-5-6	D25L120P8
BD25L150P8	P8 Ø 3-4-5-6	D25L150P8
BD25L200P8	P8 Ø 3-4-5-6	D25L200P8

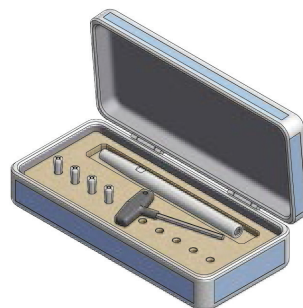

**DIN/1835A**

**Porta escariador flotante con paso refrigerante**  
*Floating reamer holder with coolant flow*

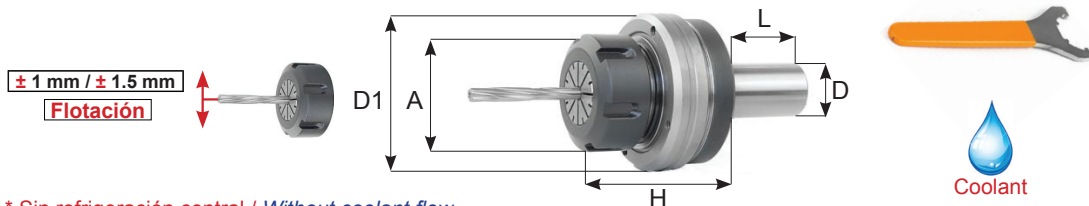

\* Sin refrigeración central / *Without coolant flow*

REFERENCIA	D	PINZA	CAP	FLOT	A	H	D1	L
D10L46RM11 *	10	ER11	D1 ÷ 7	± 1 mm	16	40	42	46
D12L46RM11 *	12							
D14L46RM11 *	14							
D16L46RM11	16							
D20L46RM11	20							
D22L46RM11	22							
D25L46RM11	25	ER16	D1 ÷ 10	± 1 mm	22	44	42	46
D10L46RM16 *	10							
D12L46RM16 *	12							
D14L46RM16 *	14							
D16L46RM16	16							
D20L46RM16	20							
D22L46RM16	22	ER20	D1 ÷ 14	± 1 mm	28	50	50	46
D25L46RM16	25							
D16L46RM20	16							
D20L46RM20	20							
D25L46RM20	25							
D16L46RM25	16				ER25			
D20L46RM25	20							
D22L46RM25	22							
D25L46RM25	25							
D32L46RM25	32							
D25L50RM32	25	ER32	D2 ÷ 22	± 1.5 mm		42	58	69
D30L50RM32	30							
D32L50RM32	32							
D25L50RM40	25							
D30L50RM40	30							
D32L50RM40	32				ER40	D3 ÷ 30		
D30L50RM40	30							
D32L50RM40	32							

Porta escariador flotante en pulgadas sobre pedido / *Floating reamer holder inch on request*

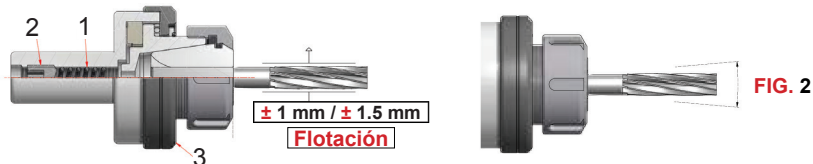

**El escariador oscila sobre un rodamiento de bolas para compensar la desalineación entre el husillo de la máquina y la pieza de trabajo.**

- El empuje del resorte 1 mantiene la herramienta centrada incluso en una posición horizontal.
- El tornillo 2 ajusta la presión del resorte para ajustar el movimiento radial.
- Al aflojar 0.1 / 0.2mm, la tuerca 3 permite que la fresa tenga un movimiento de péndulo (Fig2)

**Free moving ball bearing drive, permit to reamer to follow drilled hole of workpiece.**

- Pressure of spring 1 keeps reamer centered, even in horizontal position.
- Screwing nut 3 for 0,1/0,2mm, the reamer has a pendulum float. (Fig 2)

Porta escariador flotante super precisión con paso refrigerante  
 Floating reamer holder with coolant flow - super precision

Para torno automático CNC  
 For tool holders on CNC automatic lathes

± 0.2 mm  
 Flotación

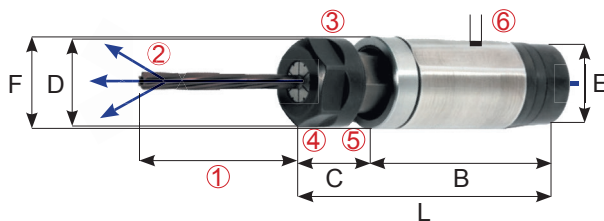

REFERENCIA	E	B	PINZA	CAP	FLOT	D	C	L	F
D3/4L65ER11HP	3/4"								19.05
D20L65ER11HP	20								20
D22L65ER11HP	22	45	ER11HP	1 ÷ 7	± 0.2 mm	19	20	65	22
D1"L65ER11HP	1"								25.4

- ① - Longitud de herramienta de 30-65 mm (según Ø)
- ② - Refrigeración Interior
- ③ - Plano de apriete - tuerca
- ④ - Tuerca y pinza oscilación 0.1-0.2 mm capacidad de 1-7 ER11 HP
- ⑤ - Tornillo de reglaje del escariador
- ⑥ - Tornillo de fijación máquina

- ① - Length of tool outside the tool holder 30 - 65 mm (depending Ø)
- ② - With through coolant, for blind or through hole
- ③ - Holding surface for nut
- ④ - Nut and collets ER11 HP Oscillation 0.1-0.2 mm Range 1-7 mm
- ⑤ - Screw to determine the fixing length of the reamer
- ⑥ - Screw to fix the PHA in the tool holder



± 0.1 mm / ± 0.3 mm  
 Flotación

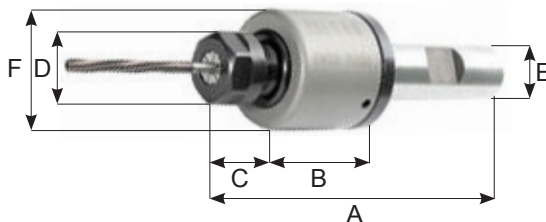

REFERENCIA	E	B	PINZA	CAP	FLOT	D	C	A	F
D10L90ER8HP	10	34	ER8 HP	1 ÷ 5	± 0.1 mm	13.5	16	90	19.5
D12L97ER11HP	12								97
D16L100ER11HP	16	32	ER11 HP	1 ÷ 7	± 0.3 mm	19	20	100	31
D20L102ER11HP	20								102
D16L85ER16HP	16								85
D20L85ER16HP	20	35	ER16 HP	1 ÷ 10	± 0.3 mm	35	20	85	50
D25L105ER16HP	25								105
D16L85ER20HP	16								85
D20L85ER20HP	20								85
D25L105ER20HP	25	35	ER20 HP	1 ÷ 13	± 0.3 mm	35	20	105	50
D1"L105ER20HP	1"								105

**DIN/1835A**

Porta brocas cilíndrico llave gancho - rotación derecha  
 Straight shank drill chucks hook wrench - Right spin

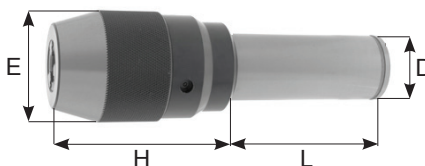

REFERENCIA	D	CAP	L	H	E
D20L60DCK13	20	1 ÷ 13	60	81	50
D25L80DCK13	25		80		
D32L60DCK13	32		60		
D40L70DCK13	40		70		
D32L60DCK16	32	3 ÷ 16	60	85	57
D40L70DCK16	40		70		

**DIN/1835A**

Porta brocas cilíndrico llave hexagonal  
 rotación derecha e izquierda  
 Straight shank drill chucks right and left spin

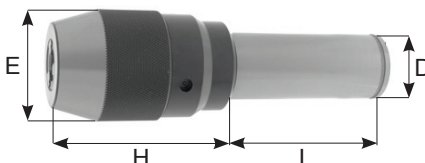
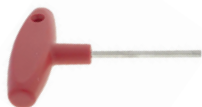

REFERENCIA	D	CAP	L	H	E
D25L70DCK13C	25	1 ÷ 13	70	82	50
D32L60DCK13C	32		60		
D40L70DCK13C	40		70		
D25L70DCK16C	25	3 ÷ 16	70	87	50
D32L60DCK16C	32		60		
D40L70DCK16C	40		70		



**DIN/1835A**

Porta brochas cilíndrico  
Rotating broach toolholder

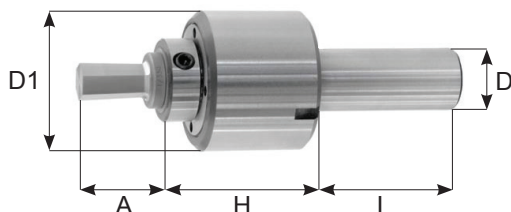

**BCH**



REFERENCIA	D	H	L	D1	A	* BCH
D8L35BCH5	8	34	35	22	10	5
D10L35BCH5	10	34	35	22	10	5
D12L35BCH5	12	34	35	22	10	5
D14L35BCH5	14	34	35	22	10	5
D16L35BCH5	16	34	35	22	10	5
D20L46BCH5	20	34	46	22	10	5
D22L46BCH5	22	34	46	22	10	5
D10L35BCH8	10	38	35	32	18	8
D12L35BCH8	12	38	35	32	18	8
D14L35BCH8	14	38	35	32	18	8
D16L35BCH8	16	38	35	32	18	8
D20L50BCH8	20	38	50	32	18	8
D22L50BCH8	22	38	50	32	18	8
D25L50BCH8	25	38	50	32	18	8
D16L50BCH12	16	46	50	44	25	12
D20L50BCH12	20	46	50	44	25	12
D22L50BCH12	22	46	50	44	25	12
D25L50BCH12	25	46	50	44	25	12
D32L50BCH12	32	46	50	44	25	12
D20L50BCH16	20	76	50	58	40	16
D25L50BCH16	25	76	50	58	40	16
D30L50BCH16	30	76	50	58	40	16
D32L50BCH16	32	76	50	58	40	16
D40L80BCH16	40	76	80	58	40	16

Porta Brochas Cilindrico en pulgadas sobre pedido / Rotating broach toolholder inch on request

**INSTRUCCIONES**

**- DIÁMETRO DE PERFORACIÓN**

Haga un orificio de 0,2-0,3 mm más grande que el tamaño P de la brocha.

**- VELOCIDAD DE ROTACIÓN 1000 - 1500 (rpm)**

- Velocidad 0.01 - 0.03 (mm / rpm)

**- Profundidad de brochado**

En este portaherramientas, es importante usar brochas de longitud A.

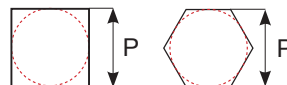

**INSTRUCTIONS**

**- DRILLING DIAMETER**

Make hole 0,2-0,3mm larger than size P of broach.

**- ROTATION SPEED 1000 - 1500 (rpm)**

- FEED 0,01 - 0,03 (mm/rpm)

**- BROACHING LENGHT**

In this toolholder is important to use broaches with lengths A.

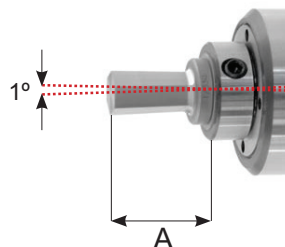



**DIN/1835A**

Porta brochas regulable  
Adjustable broach toolholder

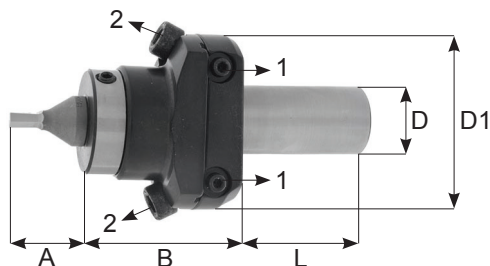

**BCH**



REFERENCIA	D	B	L	D1	A	* BCH
D10L35BCH8R	10	34	35	50	18	8
D12L35BCH8R	12	34	35	50	18	8
D14L35BCH8R	14	34	35	50	18	8
D16L35BCH8R	16	34	35	50	18	8
D20L46BCH8R	20	34	46	50	18	8
D22L46BCH8R	22	34	46	50	18	8
D25L46BCH8R	25	34	46	50	18	8

  

REFERENCIA	D	B	L	D1	A	* BCH
D20L50BCH12R	20	52	50	62	25	12
D22L50BCH12R	22	52	50	62	25	12
D25L50BCH12R	25	52	50	62	25	12
D30L50BCH12R	30	52	50	62	25	12
D32L50BCH12R	32	52	50	62	25	12

Porta Brochas Regulable en pulgadas sobre pedido / Adjustable broach toolholder inch on request

**DIN/1835A**

Topo de barras regulable con compensación  
Revolving bar stop for lathes

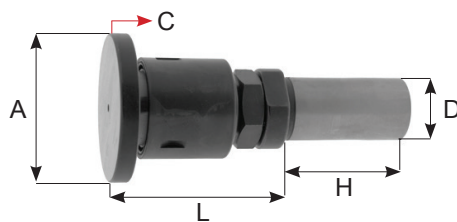

**C= Compensación**

REFERENCIA	D	L	H	A	C
D20SAS35	20	100	46	35	3
D22SAS35	22	100	46	35	3
D25SAS35	25	100	50	35	3
D30SAS35	30	100	50	35	3
D32SAS35	32	100	50	35	3
D40SAS35	40	100	85	35	3
D25SAS56	25	100	50	56	3
D30SAS56	30	100	50	56	3
D32SAS56	32	100	50	56	3
D40SAS56	40	100	85	56	3

Topo de Barras Regulable cilíndrico con Compensación en pulgadas sobre pedido  
Damped rotary adjustable bar-stop inch on request

**DIN/1835A**

Punto cilíndrico rotativo  
Revolving Tailstock

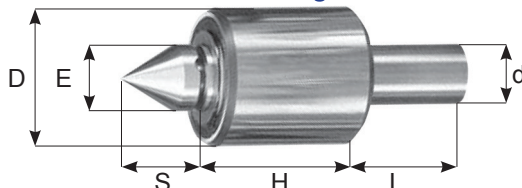

Nota: El punto cilíndrico Rotativo incluye la (Figura.1 E14S16.60°)  
Note: The rotary cylindrical point includes the (Figure.1 E14S16.60°)

REFERENCIA	d	D	E	H	L	S
D8L35D14F	8	32	14	44	35	16
D10L35D14F	10	32	14	44	35	16
D12L35D14F	12	32	14	44	35	16
D14L35D14F	14	32	14	44	35	16
D16L35D14F	16	32	14	44	35	16
D20L35D14F	20	32	14	44	46	16
D22L35D14F	22	32	14	44	46	16
D25L35D14F	25	32	14	44	46	16

Recambios para punto cilíndrico rotativo  
Interchangeable insert

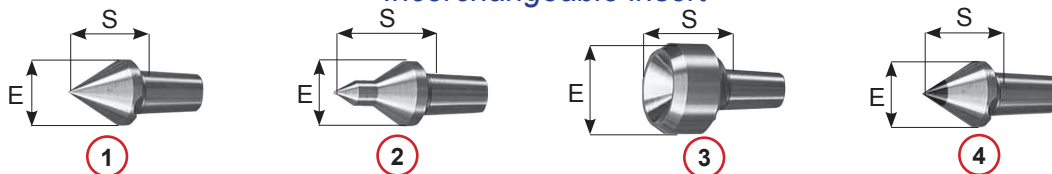

REFERENCIA	E	S	G	F	S	FIG
E14S16	14	16	-	-	60°	1
E14S22	14	22	-	-	90°	1
E14S22B	14	22	7	-	60°	2
E14S26	14	26	8	-	60°	2
E20S12	20	12	12	10	60°	3
E14S16HM (Punta metal duro)	14	16	6	-	60°	4

Porta pinzas con flangia  
Flangia Mounting

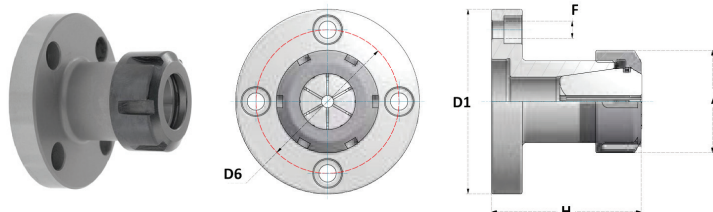

REFERENCIA	CAP	D1	D6	F	A	H
FLB50ERC32	2 ÷ 22	50	40	M6	50	58
FLB90ERC32	2 ÷ 22	90	70	M8.5	50	72
FLB110ERC40	3 ÷ 30	110	86	M8.5	63	87
FLB110ERC50	6 ÷ 34	110	86	M8.5	78	106

**DIN/1835A**

Dispositivo fijo de refrigeración central  
*Oil-feed holders*

**Distribuidor fijo de refrigerante mango cilíndrico:  
Torreta de torno - CNC**

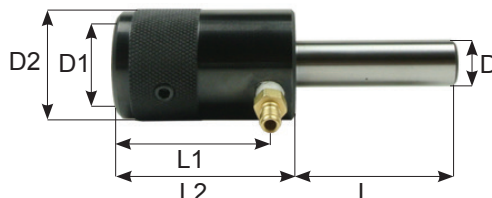

REFERENCIA	D	D1	L1	L2	D2	L
EVT316	16	16	40	55	33	47
EVT325	25	25	50	70	46	60
EVT335	35	35	60	80	58	70

**DIN/1835A**

Dispositivo rotativo de refrigeración central  
*Rotating oil-feed holders*

**Distribuidor Rotativo de refrigeración mango cilíndrico**

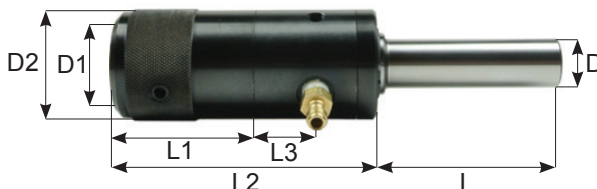

REFERENCIA	D	D1	L1	L2	D2	L3
EVT616	16	16	40	85	32	24
EVT620	20	20	50	109	46	31
EVT625	25	25	50	109	46	31

Casquillo reductor  
*Reduction sleeves*

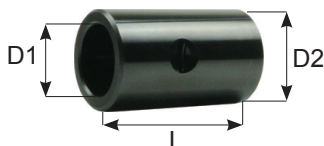

REFERENCIA	D1	D2	L
EVT25/16	16	25	50
EVT25/20	20	25	50
EVT35/25	25	35	60

Condiciones de trabajo  
*Using coolant*

Ø	PRESION	RPM
16	Hasta 4 BAR	6740
	Max 17 BAR	2000
25	Hasta 5 BAR	4600
	Max 17 BAR	1350
35	Hasta 5 BAR	2700
	Max 17 BAR	850

**DIN/1835A**

Roscador con compresión y tracción pinza ER  
Tension and compression tap holders collet ER

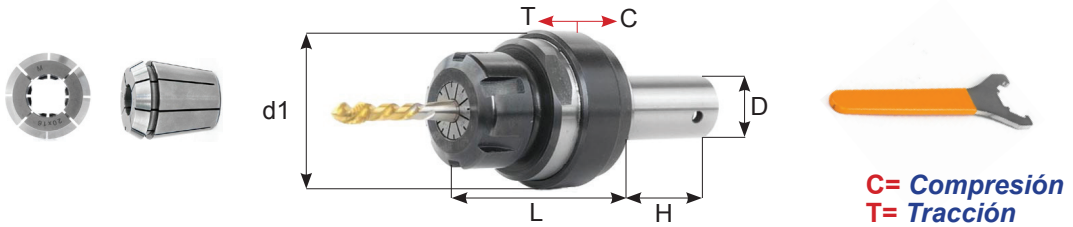

REFERENCIA	M	PINZA	D	H	L	d1	T	C
D16CTL48ER16A	M3.5 ÷ M10	ER16	16	32	48	29	5.5	2.5
D20CTL48ER16A			20					
D20CTL59ER20A	M3.5 ÷ M12	ER20	20	46	59	44	9	3
D22CTL59ER20A			22					
D25CTL59ER20A			25					
D20CTL73ER25A	M3.5 ÷ M16	ER25	20	46	73	44	9	3
D22CTL73ER25A			22					
D25CTL68ER25A	M3.5 ÷ M16	ER25	25	50	68	58	12	4
D30CTL68ER25A			30	50				
D32CTL68ER25A			32	50				
D40CTL68ER25A			40	85				
D25CTL70ER32A	M3.5 ÷ M20	ER32	25	50	70	58	12	4
D30CTL70ER32A			30	50				
D32CTL70ER32A			32	50				
D40CTL70ER32A			40	85				
D25CTL88ER40A	M5 ÷ M27	ER40	25	50	88	63	12	4
D30CTL88ER40A			30	50				
D32CTL88ER40A			32	50				
D40CTL88ER40A			40	85				

(Mango en pulgadas sobre pedido)  
(Inch on request)

**DIN/1835B**

Porta sierras  
Saw blade holder

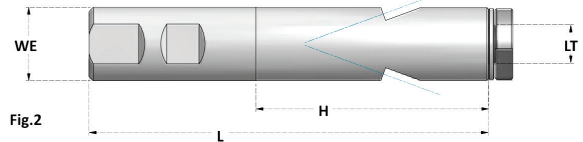
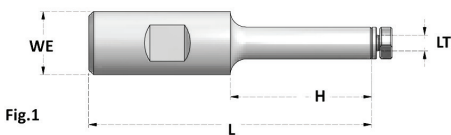

REFERENCIA	WE	A	L	H	FIG
WE20L905LT	20	5	90	40	1
WE20L1008LT	20	8	100	49	1
WE20L11010LT	20	10	110	59	1
WE25L13613LT *	25	13	136	79	2
WE25L13616LT *	25	16	136	79	2

\* Con canal de refrigeración

**DIN/1835A**

Roscador solo tracción tuerca STANDARD pinza ER  
Tension only tap holders ER collets STANDARD

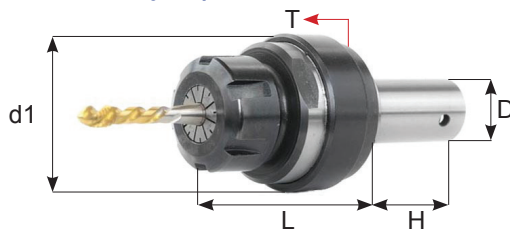

T= Tracción

REFERENCIA	M	PINZA	D	H	L	d1	T
D16TL48ER16	M3.5 ÷ M10	ER16	16	32	48	29	8
D20TL48ER16			20				
D25TL48ER16			25				
D20TL56ER20	M3.5 ÷ M12	ER20	20	46	56	44	12
D22TL56ER20			22				
D25TL56ER20			25				
D20TL70ER25	M3.5 ÷ M16	ER25	20	46	70	44	12
D22TL70ER25			22				
D25TL70ER25			25				
D25TL64ER25	M3.5 ÷ M16	ER25	25	50	64	58	16
D30TL64ER25			30	50			
D32TL64ER25			32	50			
D40TL64ER25			40	85			
D25TL66ER32	M3.5 ÷ M20	ER32	25	50	66	58	16
D30TL66ER32			30	50			
D32TL66ER32			32	50			
D40TL66ER32			40	85			
D25TL84ER40	M5 ÷ M27	ER40	25	50	84	63	16
D30TL84ER40			30	50			
D32TL84ER40			32	50			
D40TL84ER40			40	85			



**DIN/1835A**

**Roscador solo tracción Pinza ER MINI**  
*Tension only tap holders ER collets MINI*

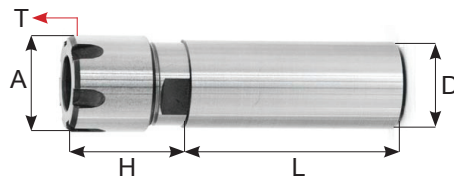

REFERENCIA	CAP	D	L	H	A	T
D16PMTL40ER16M	M3.5 ÷ M10	16	40	36	22	10
D20PMTL50ER16M		20	50	30	22	14
D20PMTL70ER16M		20	70	30	22	14
D20PMTL120ER16M		20	120	30	22	14
D22PMTL50ER16M		22	50	30	22	14
D22PMTL80ER16M		22	80	30	22	14
D22PMTL120ER16M		22	120	30	22	14
D25PMTL50ER16M		25	50	30	22	14
D25PMTL70ER16M		25	70	30	22	14
D25PMTL120ER16M		25	120	30	22	14
D20PMTL50ER20M	M3.5 ÷ M10	20	50	40	28	14
D20PMTL70ER20M		20	70	40	28	14
D20PMTL120ER20M		20	120	40	28	14
D22PMTL50ER20M		22	50	40	28	14
D22PMTL80ER20M		22	80	40	28	14
D22PMTL120ER20M		22	120	40	28	14
D25PMTL50ER20M	M3.5 ÷ M10	25	50	40	28	14
D25PMTL70ER20M		25	70	40	28	14
D25PMTL120ER20M		25	120	40	28	14
D20PMTL50ER25M		20	50	42	35	14
D20PMTL70ER25M		20	70	42	35	14
D20PMTL120ER25M		20	120	42	35	14
D22PMTL50ER25M		22	50	42	35	14
D22PMTL80ER25M	22	80	42	35	14	
D22PMTL120ER25M	22	120	42	35	14	
D25PMTL50ER25M	25	50	42	35	14	
D25PMTL70ER25M	25	70	42	35	14	
D25PMTL120ER25M	25	120	42	35	14	

**DIN/1835A**

**Roscador solo tracción pinza ER MINI doble**  
*MINI Double - Seated floating tap holder with extension*

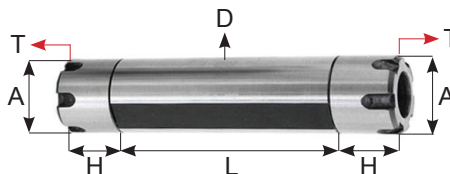

REFERENCIA	CAP	PINZA	D	L	H	A	T
D22PMTL50ER16MD	M3.5 ÷ M10	ERC16	22	50	26	22	8
D22PMTL60ER16MD			22	60	26	22	8
D22PMTL95ER16MD			22	95	26	22	8
D25PMTL50ER16MD			25	50	26	22	8
D25PMTL60ER16MD			25	60	26	22	8

**DIN/1835B**

Rosgador con compresión y tracción Weldon Din 1835 B+E  
Weldon Din 1835 B+E - Tension / Compression Tap Holders

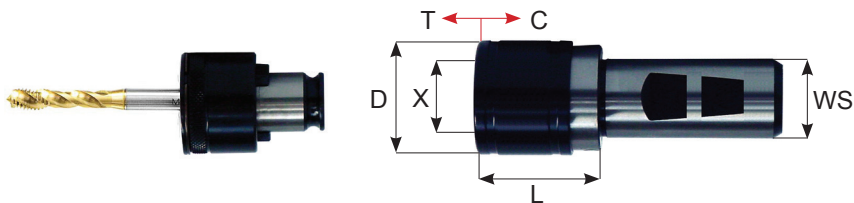

REFERENCIA	WS	CAP	X	D	L	C	T
WS16-THTC0-L37	16	M 1 ÷ M10	13	26	37	6.5	6.5
WS20-THTC0-L37	20						
WS20-THTC1-L40	20	M 3 ÷ M12	19	36	40	7.5	7.5
WS25-THTC1-L40	25						
WS32-THTC1-L40	32						
WS40-THTC1-L40	40						
WS25-THTC2-L63	25	M 8 ÷ M20	31	53	63	12.5	12.5
WS32-THTC2-L63	32						
WS40-THTC2-L63	40						
WS32-THTC3-L125	32	M14 ÷ M33	48	78	125	20.0	20.0
WS40-THTC3-L125	40						
WS40-THTC4-L126	40	M22 ÷ M48	60	96	126	22.5	22.5
WS50-THTC4-L126	50						
WS3/4"-THTC1-L40	3/4"	M 3 ÷ M12	19	36	40	7.5	7.5
WS1"-THTC1-L40	1"						
WS1"-THTC2-L63	1"	M 8 ÷ M20	31	53	63	12.5	12.5
WS1-1/2"-THTC3-L125	1-1/2"						

**DIN/1835B**

Rosgador rígido Weldon Din 1835 B+E  
Weldon Din 1835 B+E - Rigid tap holders

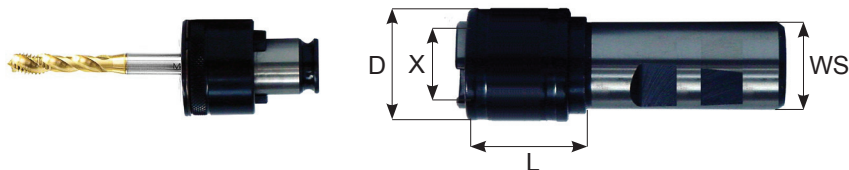

REFERENCIA	WS	CAP	X	D	L
WS16-TLR0-L37	16	M 1 ÷ M10	13	23	37
WS20-TLR0-L37	20				
WS20-TLR1-L37	20	M 3 ÷ M12	19	32	37
WS25-TLR1-L37	25				
WS25-TLR2-L56	25	M 8 ÷ M20	31	50	56
WS32-TLR3-L83	32				
WS32-TLR4-L106	32	M22 ÷ M48	60	95	106

**DIN/1835B**

Rosgador weldon Din/1835 B+E con compresión y tracción  
Synchro paso refrigerante  
Weldon Din 1835 B+E - Tension / Compression Tap Holders  
with coolant thru

**Max. 50 BAR**

**SYNCHRO**

**SES**  
Refrigeración  
Central

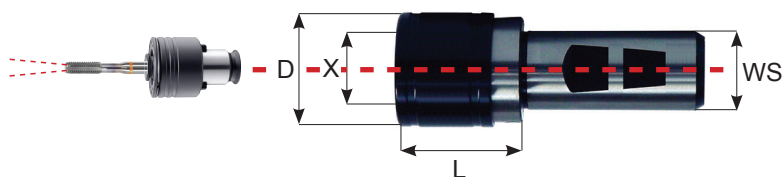

Refrigeración  
Interna  
Coolant flow



Coolant

REFERENCIA	WS	CAP	X	D	L	MODELO
WS16-THTC0-L27C	16	M 3 ÷ M12	13	26	27	SYNCHRO
WS20-THTC1-L46C	20	M 3 ÷ M12	19	36	46	SYNCHRO
WS25-THTC1-L46C	25	M 3 ÷ M12	19	36	46	SYNCHRO
WS25-THTC2-L74C	25	M 8 ÷ M20	31	53	74	SYNCHRO
WS32-THTC2-L74C	32	M 8 ÷ M20	31	53	74	SYNCHRO
WS25-THTC3-L107C	25	M14 ÷ M36	48	78	107	SYNCHRO
WS32-THTC3-L107C	32	M14 ÷ M36	48	78	107	SYNCHRO

**DIN/1835A**

Rosgador con compresión y tracción Synchro pinza ER  
Tension and compression tap holders Synchro collet ER

**SYNCHRO**

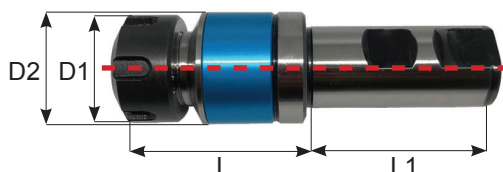

Refrigeración  
Interna  
Coolant flow

**Max. 50 BAR**

Refrigeración interna  
Coolant flow

(A)



Standard  
Standard

(B)



Coolant

REFERENCIA	COLLET	CAP	D	D1	D2	L1	L	C	T
WE20L58SYER16M	ER16M	M 3 ÷ M12	20	22	34	51	58	0.5	0.5
WE20L58SYER16	ER16	M 3 ÷ M12	20	32	34	51	58		
WE25L60SYER16M	ER16M	M 3 ÷ M12	25	22	34	56	60		
WE25L60SYER16	ER16	M 3 ÷ M12	25	32	34	56	60		
WE25L61SYER20	ER20	M 3 ÷ M16	25	35	34	56	61		
WE25L65SYER25	ER25	M 3 ÷ M20	25	42	45	56	65		
WE25L87SYER32	ER32	M 4 ÷ M27	25	50	45	56	87		
WE32L108SYER40	ER40	M 6 ÷ M33	32	63	62	61	108		



**DIN/1835A**

Alargadera "Metal Duro" mango roscado  
"MD" Screw in mill extension

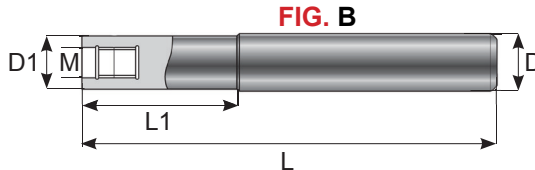
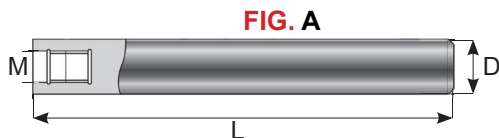

REFERENCIA	D	D1	L	L1	M	FIG	REFERENCIA	D	D1	L	L1	M	FIG
CY9L75M5	9	-	75	-	5	A	CY20L150M10	20	-	150	-	10	A
CY9L100M5	9	-	100	-	5		CY20L200M10	20	-	200	-	10	
CY9L150M5	9	-	150	-	5		CY20L250M10	20	-	250	-	10	
CY10L75M5	10	-	75	-	5		CY20L300M10	20	-	300	-	10	
CY10L100M5	10	-	100	-	5		CY20L350M10	20	-	350	-	10	
CY10L150M5	10	-	150	-	5	CY20L250M10	20	19	250	80	10	B	
CY10L75M5	10	9	75	20	5	CY20L300M10	20	19	300	100	10		
CY10L100M5	10	9	100	40	5	CY20L350M10	20	19	350	120	10	A	
CY10L150M5	10	9	150	40	5	CY24L100M12	24	-	100	-	12		
CY11L100M6	11	-	100	-	6	CY24L150M12	24	-	150	-	12		
CY11L150M6	11	-	150	-	6	CY24L200M12	24	-	200	-	12		
CY11L200M6	11	-	200	-	6	CY24L250M12	24	-	250	-	12		
CY12L100M6	12	-	100	-	6	CY24L300M12	24	-	300	-	12		
CY12L150M6	12	-	150	-	6	CY24L350M12	24	-	350	-	12		
CY12L200M6	12	-	200	-	6	CY25L100M12	25	-	100	-	12		
CY12L100M6	12	11	100	40	6	CY25L150M12	25	-	150	-	12		
CY12L150M6	12	11	150	40	6	CY25L200M12	25	-	200	-	12		
CY12L200M6	12	11	200	40	6	CY25L250M12	25	-	250	-	12		
CY15L100M8	15	-	100	-	8	CY25L300M12	25	-	300	-	12		
CY15L150M8	15	-	150	-	8	CY25L350M12	25	-	350	-	12		
CY15L200M8	15	-	200	-	8	CY25L100M12	25	24	100	40	12	B	
CY15L250M8	15	-	250	-	8	CY25L150M12	25	24	150	60	12		
CY15L300M8	15	-	300	-	8	CY25L200M12	25	24	200	60	12		
CY16L100M8	16	-	100	-	8	CY25L250M12	25	24	250	80	12		
CY16L150M8	16	-	150	-	8	CY25L300M12	25	24	300	120	12	A	
CY16L200M8	16	-	200	-	8	CY25L350M12	25	24	350	140	12		
CY16L250M8	16	-	250	-	8	CY31L150M16	31	-	150	-	16		
CY16L300M8	16	-	300	-	8	CY31L200M16	31	-	200	-	16		
CY16L100M8	16	15	100	40	8	CY31L250M16	31	-	250	-	16		
CY16L150M8	16	15	150	40	8	CY31L300M16	31	-	300	-	16		
CY16L200M8	16	15	200	60	8	CY31L350M16	31	-	350	-	16		
CY16L250M8	16	15	250	80	8	CY31L400M16	31	-	400	-	16		
CY16L300M8	16	15	300	100	8	CY32L150M16	32	-	150	-	16		
CY19L100M10	19	-	100	-	10	CY32L200M16	32	-	200	-	16		
CY19L150M10	19	-	150	-	10	CY32L250M16	32	-	250	-	16		
CY19L200M10	19	-	200	-	10	CY32L300M16	32	-	300	-	16		
CY19L250M10	19	-	250	-	10	CY32L350M16	32	-	350	-	16		
CY19L300M10	19	-	300	-	10	CY32L400M16	32	-	400	-	16		
CY19L350M10	19	-	350	-	10	CY32L150M16	32	31	150	60	16	B	
CY20L100M10	20	-	100	-	10	CY32L200M16	32	31	200	80	16		
CY20L100M10	20	19	100	40	10	CY32L250M16	32	31	250	100	16		
CY20L150M10	20	19	150	60	10	CY32L300M16	32	31	300	120	16		
CY20L200M10	20	19	200	60	10	CY32L350M16	32	31	350	140	16		
						CY32L400M16	32	31	400	160	16		

DIN/1835A

Alargadera "Acero" Mango Roscado  
"Steel" Screw in mill extensions with flats

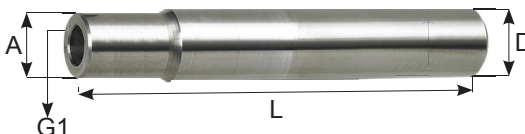

REFERENCIA	D	A	L	G1	REFERENCIA	D	A	L	G1
D12L65M5CPY	12	10	65	M5	D20L125M10CPY	20	17.8	125	M10
D20L75M6CPY	20	10	75	M6	D20L150M10CPY	20	17.8	150	M10
D20L100M6CPY	20	10	100	M6	D25L81M12CPY	25	20.8	81	M12
D20L125M6CPY	20	10	125	M6	D25L101M12CPY	25	20.8	101	M12
D16L88M8CPY	16	12.8	88	M8	D25L131M12CPY	25	20.8	131	M12
D20L75M8CPY	20	12.8	75	M8	D25L170M12CPY	25	20.8	170	M12
D20L100M8CPY	20	12.8	100	M8	D25L181M12CPY	25	20.8	181	M12
D20L125M8CPY	20	12.8	125	M8	D32L170M12CPY	32	28.8	170	M12
D20L150M8CPY	20	12.8	150	M8	D32L85M16CPY	32	28.8	85	M16
D20L75M10CPY	20	17.8	75	M10	D32L105M16CPY	32	28.8	105	M16
D20L80M10CPY	20	17.8	80	M10	D32L135M16CPY	32	28.8	135	M16
D20L100M10CPY	20	17.8	100	M10	D32L185M16CPY	32	28.8	185	M16

DIN/1835A

Porta cilíndrico inducción térmico  
Thermo chucks cylindrical shanks

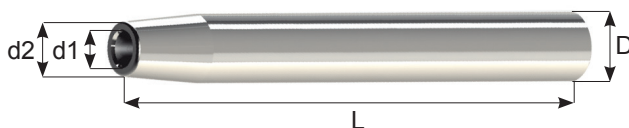

REFERENCIA	D	d1	d2	L	REFERENCIA	D	d1	d2	L
D12L150CL3	12	3	8	150	D20L150CL12	20	12	16	150
D12L150CL4	12	4	8	150	D25L150CL8	25	8	20	150
D16L150CL3	16	3	10	150	D25L150CL10	25	10	20	150
D16L150CL4	16	4	10	150	D25L150CL12	25	12	20	150
D16L150CL5	16	5	10	150	D25L150CL14	25	14	20	150
D16L150CL6	16	6	10	150	D25L150CL16	25	16	22	150
D20L150CL3	20	3	10	150	D32L150CL10	32	10	24	150
D20L150CL4	20	4	10	150	D32L150CL12	32	12	24	150
D20L150CL5	20	5	10	150	D32L150CL14	32	14	27	150
D20L150CL6	20	6	10	150	D32L150CL16	32	16	27	150
D20L150CL8	20	8	12	150	D32L150CL18	32	18	27	150
D20L150CL10	20	10	14	150	D32L150CL20	32	20	27	150